



DOMINATOR SUN VISOR INSTALLATION GUIDE V2

REQUIRED MATERIALS

NOT INCLUDED

- Power drill
- Drill bit 4mm
- Drill bit 9mm
- Drill bit 12mm
- Optional: Step drill bit (Unibit) 4-20mm
- Deburrer
- Rivet nut tool (Nutsert tool) with M6 adapter
- Flexible sealant
- White grease/tread grease
- Primer
- Grommet/rubber wiring sleeve
- Masking tape
- Pen/marker
- Cloths and degreaser cleaner

INCLUDED

- 2x Mounting plates for sun visor (Left has a hole for grommet, right is without a hole)
- 5-Lobe security bit (Pentagon)
- 4x M8 nuts
- 8x M6 5-Lobe security bolts
- 8x M6 rivet nuts

PREPARATION

[01] TAPING

Mask the surface of the mounting plates, the seams and the front window.

[02] MARKING

Firstly mount the mounting plates onto the the sun visor, then mark te positions. The positin will be 5mm to 10mm from the inside of the A-pillar to the mounting plate.

02-1 | MAN TGE, VW Crafter:

[MOUNTING HEIGHT CORRECTED]

From the bottom of the A-pillar at the fold: Measure 76cm to the underside of the mounting plate. (important: keep the bottom rivet nut strictly below the weld seam!) You may choose the more 'aesthetic' 73 cm mounting height, but please note this is outside of the recommended specifications is at your own discretion and liability.

02-2 | Mercedes Sprinter:

Attach the top of the mounting plate below the weld seam at the top of the A-pillar.

[03] COLLECTING SHAVINGS

Fold a "bowl" out of tape to catch the metal shavings while drilling.

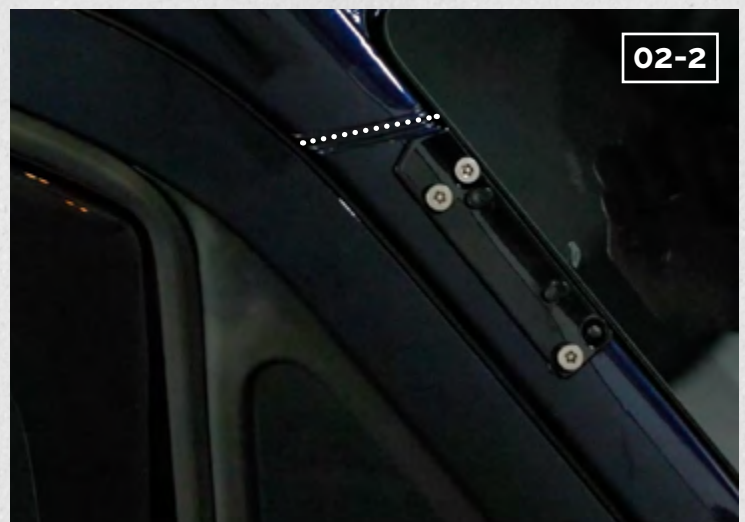

INSTALLATION

[04] DRILLING

Pre-drill the holes with the 4mm drill bit.

[05] DRILLING TO SIZE

Drill them out to 9mm, and drill the hole for the grommet to 12mm.

[06] PRIMER

Apply primer to the holes

[07] RIVNUT

Insert the Rivet nuts and secure them with the Rivet nut tool

[08] GREASE

Apply a small amount of grease into the Rivet nuts

[09] SEALING

Apply sealant/adhesive into the Rivet nuts and onto the surface of the mounting plates. Use the flexible sealant to draw a rectangle shape like shown to the right ->

[10] MOUNTING PLATES

Mount the mounting plates with the bolts (M6) and wipe away any excess sealant.

[11] M8

Mount the M8 nuts

[12/13] WIRING

Feed the cable trough and install the grommet. Tape the cable down for easy assembly.

ASSEMBLING

[14] MOUNTING PLATES

First feed the nuts trough the larger hole, then let de visor drop down to secure it.

[15] TIGHTENING

Tighten the nuts

[16] CLEANING

Clean the sun visor and the surrounding surface and admire the finished result.

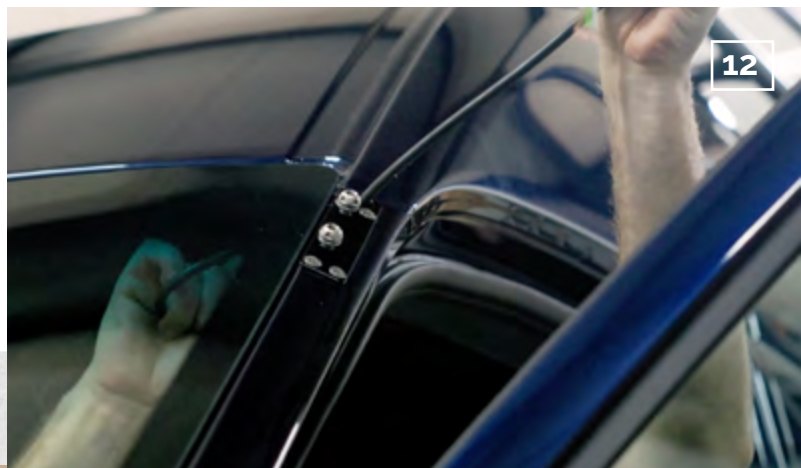
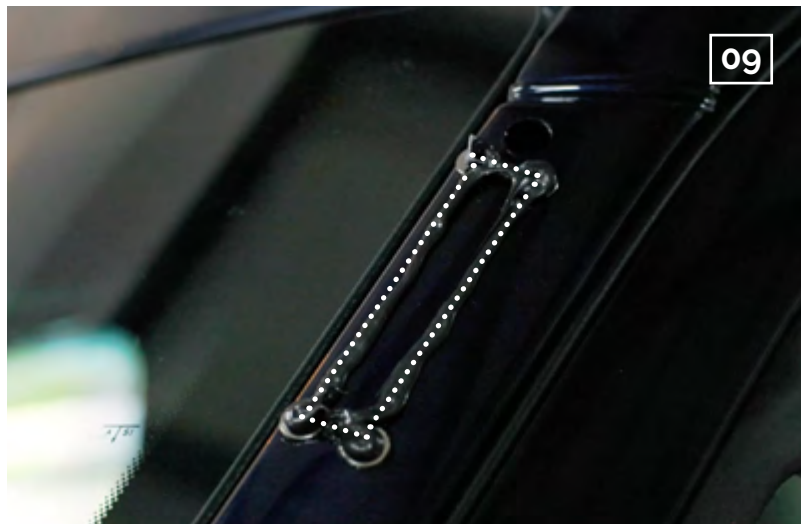



WELULIGHTING.NL/SUPPORT
INSTALLATION VIDEO + PDF DOWNLOAD

